

Thank you for purchasing a National Cycle product. Read these instructions carefully and thoroughly before beginning work. Dealers, if installing this windscreen for a customer, please give them this manual. It contains information needed to properly maintain and use this product.



Attention:

Special notes and cautionary measures which can prevent damage to the accessory or motorcycle.



Note:

Tips for facilitation of operation, control and adjustment, as well as maintenance work.

CONTENTS OF KIT

Item	Description	Part No.	Qty.	Notes and Installation Tools
1	VStream® Windscreen	(N20315 shown)	1	
HARDWARE KIT				
2	Bracket	37-374470-000	1	5mm Hex Wrench
Bag#1175				
3	Grommet	44-447350-000	4	
4	Cap, Aluminum, Black	34-346047-000	4	
5	Screw, Flat, M6 x 20	51-514221-000	4	4mm Hex Wrench
6	Collar, .354 L	49-495592-000	4	
7	Nut, Flange M6	42-483005-000	4	10mm Box Wrench
8	Spacer, Black	44-443542-000	2	



Bag#1175



TOOLS

5mm and 4mm Hex Wrench
 10mm Box Wrench





Figure 1



Figure 2

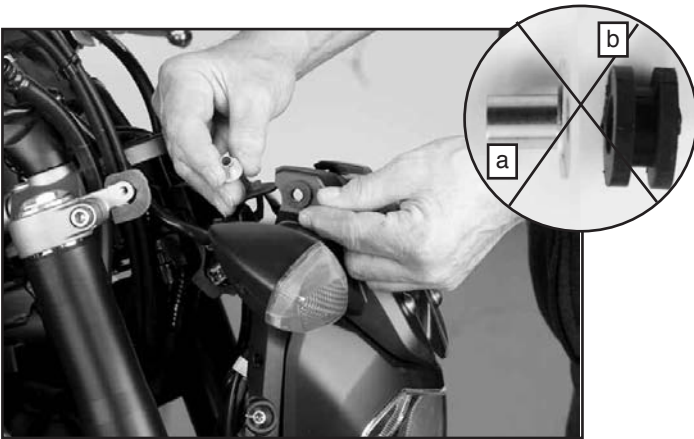

Figure 3



Figure 4

PREPARATION

1. Position motorcycle securely on its side stand.

INSTALLATION

Installation of new Spacer from Bag#1175

1. Remove stock screws from the right and left side of the headlight cover. These screws will be re-used.

(5mm Hex Key) Figure 1

2. Rotate headlight assembly forward.

Figure 2

3. Remove the stock spacer (a) and rubber bushing (b) from the headlight cover. These parts will not be re-used.

Figure 3 and 4

4. When parts are removed headlight cover will appear as shown in Figure 4.

Figure 4



Figure 5



Figure 6

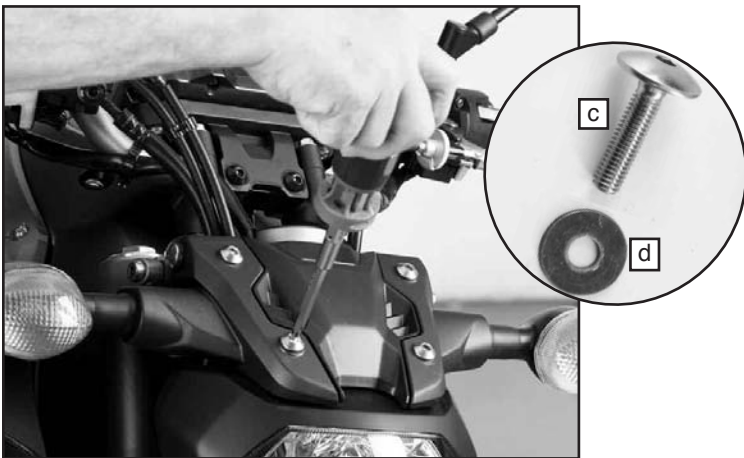

Figure 7



Figure 8

INSTALLATION Continued

5. From the outside of the headlight cover, install Spacers (8) into the holes on the left and right sides of the motorcycle.

Figure 5

6. Swing headlight housing back into place. Replace stock screws. **Tighten firmly.**

Figure 6 (5mm Hex Key)

7. Remove the stock screws (c) and the washer (d) from the front of the headlight cover. These screws will be re-used.

Figure 7 (5mm Hex Key)

Install Bracket

8. Place Bracket (2) onto headlight cover. Install Bracket using the four stock screws and washers. **Tighten firmly.**

(5mm Hex Key) Figure 8



Figure 9

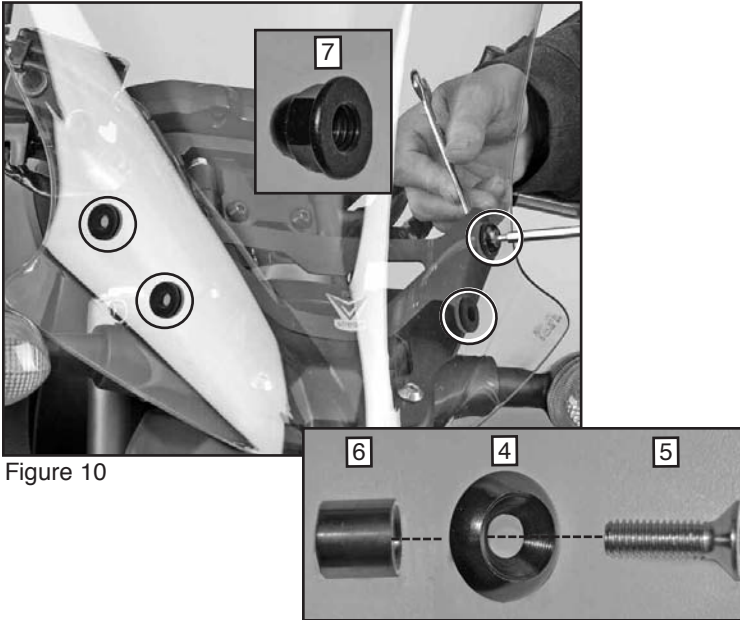

Figure 10

INSTALLATION Continued

9. Install one Grommet (3) into each hole on the windscreen.

Figure 9

Install Windscreen To Bracket

10. Make four screw assemblies using one each:

- M6 Flat Screw (5)
- Cap (4)
- Collar (6)

Install windscreen onto Bracket using the four screw assemblies and Nut (7). Repeat procedure at all four holes. **Tighten screws firmly.** **Figure 10. (3mm Hex Key and Box Wrench)**



Ask for Shield Wash™ and RainZip® at your local dealer or visit www.nationalcycle.com.

CLEANING AND MAINTENANCE

To clean the screen, wash with a clean soft cloth, plenty of warm water and, if necessary, a non-abrasive soap such as dishwashing liquid. Flannel or soft chamois make good cleaning cloths. **Paint, glue residue or grease removal:** Moisten cotton with naphtha or turpentine followed by a wash as above.

National Cycle **Shield Wash™** (N1401-01) makes a good daily cleaner and comes with a handy travel-size bottle. Shield Wash is safe for all windshields and helmet visors.

Do not clean polycarbonate in hot sun or high temperatures. Do not clean the screen with glass cleaners.

Do not allow brake fluid, alcohol, or strong solvents to contact the screen.

RAIN REPELLENT

Do not use rain protective products made for glass. We recommend National Cycle's **RainZip®** (N1410-01) to keep your windshield clear in rainy weather.



Register your windshield online at www.nationalcycle.com

National Cycle 3-Year Limited Warranty

National Cycle hereby warrants to the original registered owner of a National Cycle polycarbonate windshield for a period of three years from the date of purchase against breakage. This limited warranty is expressly limited to the replacement of the polycarbonate windshield. This limited warranty does not include scratches, coating failure, cosmetic wear and tear, replacement of hardware, or any consequential damages or expenses including labor cost of installation, removal and/or replacement, inconvenience, inbound freight expenses or damage to any other component of the motorcycle or any other accessories. Certain chemicals, generally known as acidic hydrocarbons, are known to cause polycarbonate damage and will not be covered under this limited warranty. Please refer to the cleaning instructions supplied with all National Cycle windshields.

Visit www.nationalcycle.com for further details, or call or write National Cycle

! WARNING

Never ride your motorcycle with loose accessory mounting hardware. Check the hardware for tightness regularly.

Today's motorcycles are built with enough frame rigidity to withstand the moderate loads imposed on them by the foreseeable addition of an accessory(ies). If an accessory(ies) adversely affects your motorcycle's stability, immediately remove the accessory(ies). Do not ride a motorcycle that exhibits unsafe handling traits.

Have experienced service personnel correct any problem before riding with the accessory(ies) installed. For further questions concerning handling problems associated with an accessory(ies), contact your dealer, motorcycle manufacturer, or accessory manufacturer.

Sunlight reflected off the inside curvature of the windshield can, at certain times of day, cause extreme heat buildup on the motorcycle instruments and possibly even melt them. Exercise care in parking to avoid this. Park your motorcycle facing the sun or place an opaque object over this area.

VStream® windshield patent no. 7,387,328