

Read these instructions carefully and thoroughly before beginning work. Dealers installing this windshield for a customer please give them this manual. It contains information needed to properly maintain and use this product.



### Attention:

Special notes and cautionary measures which can prevent damage to the accessory or motorcycle.



### Note:

Tips for facilitation of operation, control and adjustment, as well as maintenance work.

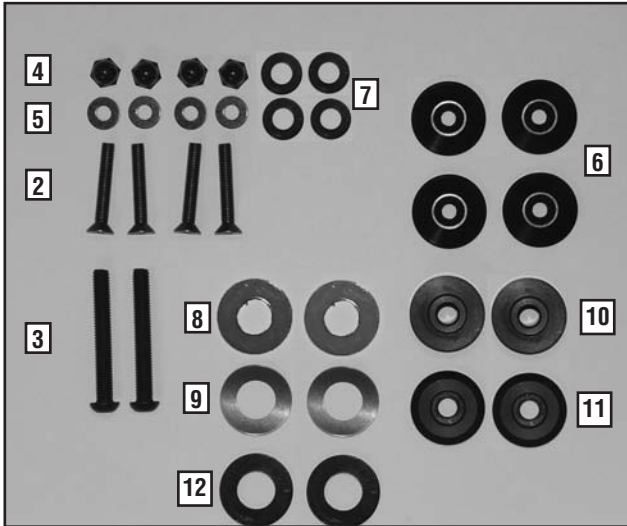

BAG #661



Figure 1





Figure 2

**Tools:** 3mm Hex Key    5mm Hex Key  
10mm Wrench    3/8" Wrench

Item	Description	Qty.
<b>Z2243</b>		
1	Windsheild	1
<b>BAG #661</b>		
2	51-514511-000 Screw, Flat 10-32 x 5/8"	4
3	51-518245-000 Screw, Button M6-1.0 x 45	2
4	42-480201-000 Nut 10-32 Acorn	4
5	49-490530-000 Washer #10 Black	4
6	49-495413-000 Cap, Screw Head for Upper Arm	4
7	75-762018-000 Washer, with PS Adhesive	4
8	49-490212-000 Washer, Nylon Black	2
9	80-871015-000 Washer, Spring Wave	2
10	34-340352-000 Lower Standoff	2
11	49-495416-000 Cap, Screw Head for Lower Arm	2
12	49-490561-000 Washer, Flat Black Steel	2
<b>BAG #679 LEFT ARM ASSEMBLY</b>		
<b>RIGHT ARM ASSEMBLY</b>		

### PREPARATION

 At the front attachment point, some R 1200 GS models have front bushings isolating the hole of the stock windshield. If you have these bushings, they will *not* be re-used in the installation of your new ZTechnik Windshield.

 The ZTechnik windshield will be installed using the stock top hat (a) and acorn nut (b) from the inside of the windshield. All other stock parts from the side will not be re-used. Store these parts in a safe place.

 When removing the stock top hat (a) and acorn nut (b) located inside the side bracket take care that these items do not fall to the inside of the motorcycle.

1. Remove the stock windshield. **Figure 1 and 2.**

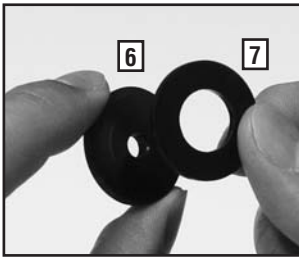

Figure 4.

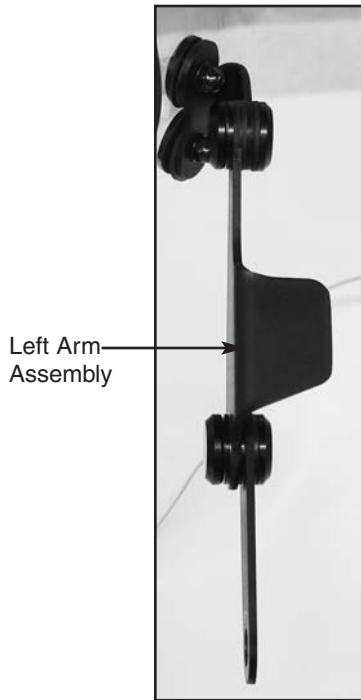

Figure 3.

## INSTALLATION

### Assemble the Left and Right Articulating Arms to the Windshield.

1. Identify the Left Arm Assembly. Apply two Washers with PS adhesive (7) to the Cap Screw Head (6). **Figure 3 and 4.**
2. Insert a Flat Screw (2) through the Cap Head (6) **Figure 5.**
3. Install the left arm to windshield using the Screw Assembly, #10 Washers (5) and Acorn Nuts (4). Finger Tighten. **Figure 5, 6 and 7.**
4. Repeat for Right Arm.
5. Tighten Firmly. **(3mm Hex Key and 3/8" Wrench) Figure 8.**

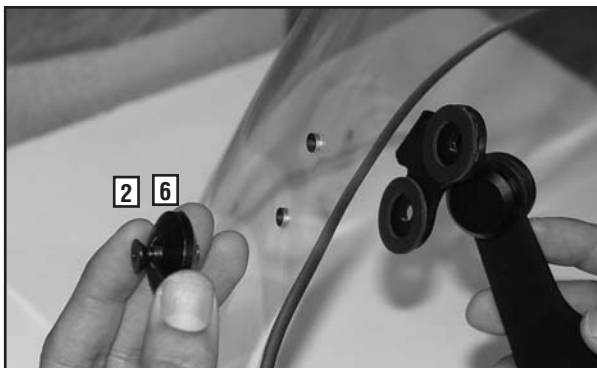

Figure 5.



Figure 6.

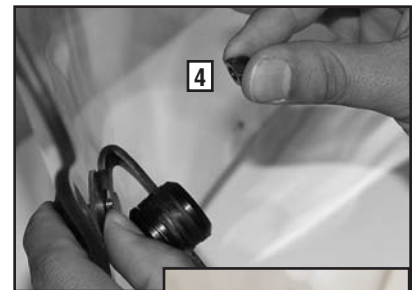

Figure 7.

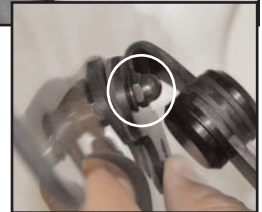

Figure 8.

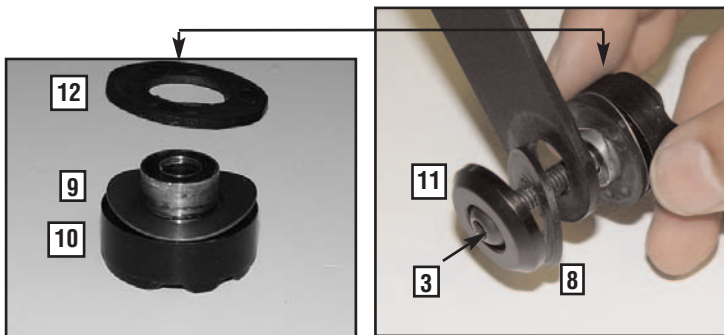

Figure 9

Figure 10

### Lower Standoff Assembly

6. On the Lower Standoff place a Spring Wave Washer (9) (washer curves upward) and a Flat Washer (12).

**Figure 9.**

7. Install this assembly to the left arm using the M6 Screw (3) Cap Screw Head (11) and Nylon Washer (8).

**Figure 10.**

8. Repeat for right side.

### Installing Windshield to Motorcycle

9. Place windshield on motorcycle. Lower Standoff assembly goes to outside of bracket. Secure with stock Top Hat and Acorn Nut. **Figure 11.**

10. Tighten screws firmly (5mm Hex Key and 10mm Wrench.) **Figure 12.**

11. Install windshield to stock hardware at front (3mm Hex Key.) **Figure 13.**



The Acorn Nut is designed to “bottom-out” when tightened. It prevents the Top Hat Assembly from being removed when adjusting the windshield rake angle.

12. Check that all hardware is tight. There will be a slight gap between the Top Hat and the Acorn Nut at the sides.



Figure 11

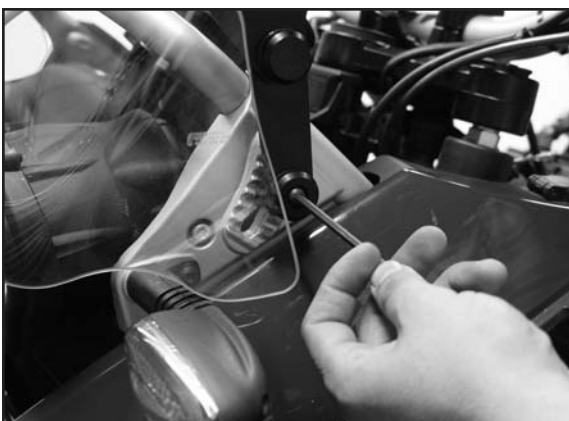
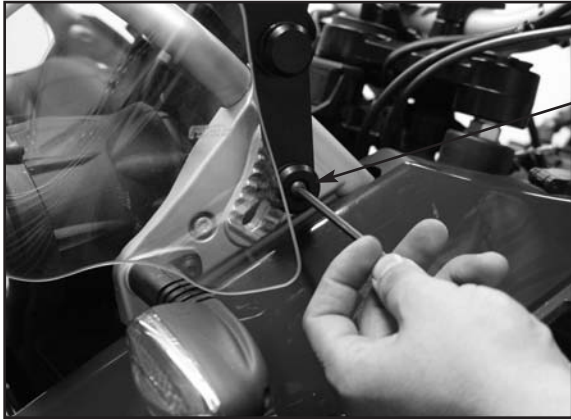

Figure 12



Figure 13





## ADJUSTMENT

Set the articulating arm at the stock BMW rake adjustment feature at the height you want (for the first time, we suggest starting at the center position) and then use the tab on the articulating arms to adjust to your actual riding conditions. (5mm Hex Key)



Stop Motorcycle. Use both hands and push the tabs on the articulating arms forward and your windshield will take a full upright position. Pull back on tabs to lower screen.

## MAINTENANCE

To clean the screen, wash with a clean soft cloth, plenty of warm water and if necessary, a non-abrasive soap such as dishwashing liquid. Flannel or soft chamois make good cleaning cloths. **Paint, glue residue or grease removal:** Moisten cotton with Naphtha or Turpentine followed by a wash as above. National Cycle Shield Wash™ makes a good daily cleaner and comes with a handy travel size bottle. N1401 Shield Wash is safe for helmet visors.

Do not clean polycarbonate in hot sun or high temperatures. Do not clean the screen with glass cleaners. Do not use rain protective products on the screen other than National Cycle brand Rain Slick® (Part No. N1410). Do not allow brake fluid, alcohol, or strong solvents to contact the screen.



### ZTechnik 3-Year Limited Warranty

Register your windshield on Line at: [www.ZTechnik.com](http://www.ZTechnik.com)

ZTechnik hereby warrants to the original registered owner of a ZTechnik polycarbonate windshield for a period of three years from the date of purchase against breakage. This limited warranty is expressly limited to the replacement of the polycarbonate windscreen. This limited warranty does not include scratches, coating failure, cosmetic wear and tear, replacement of hardware, or any consequential damages or expenses including labor cost of installation, removal and/or replacement, inconvenience, inbound freight expenses or damage to any other component of the motorcycle or any other accessories. Certain chemicals, generally known as acidic hydrocarbons, are known to cause polycarbonate damage and will not be covered under this limited warranty. Please refer to the cleaning instructions supplied with all ZTechnik windshields.

Visit [www.ZTechnik.com](http://www.ZTechnik.com) for further details or call or write ZTechnik / PO Box 158 / Maywood, IL 60153 / 708-3430400

View other ZTechnik® products for the R 1200 GS on line at:

[www.ZTechnik.com](http://www.ZTechnik.com) or [www.nationalcycle.com](http://www.nationalcycle.com)

ENGINE GUARDS • CARBON FIBER KITS • EXHAUST SYSTEMS • STORAGE POD • ACCESSORY STANDS

ZTechnik PO Box 158 Maywood, IL 60153-0158 USA

708-343-0400 / Fax: 708-343-0625 / [www.ZTechnik.com](http://www.ZTechnik.com) / email: [info@ZTechnik.com](mailto:info@ZTechnik.com)